

HOBART		GENERAL LEGEND			
AW	= drain water	KW	= cold water	AFFL	= above finished floor level
Dat	= dataline	KWw	= cold water soft	SFB	= separate filling-boiler
EZ	= power line (supply)	LR	= conduit Ø	VEW	= demineralized water
FD	= floor opening	CNS	= stainless steel (inox)	WD	= wall opening
HW-VL	= hot water flow	MK	= supply chanell	WS	= wall slot
HW-RL	= hot water return	PA	= equipotential conductor	WW	= warm water
KB	= cored hole Ø	STL	= control line	WWw	= warm water soft

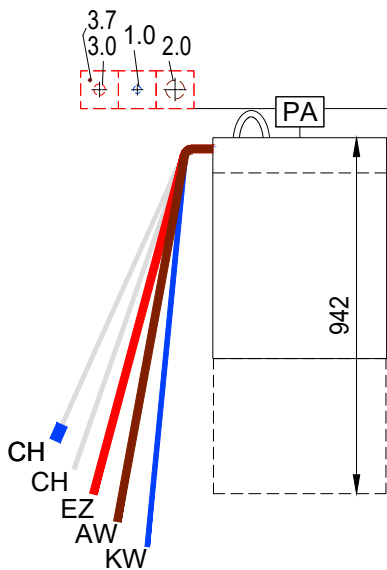
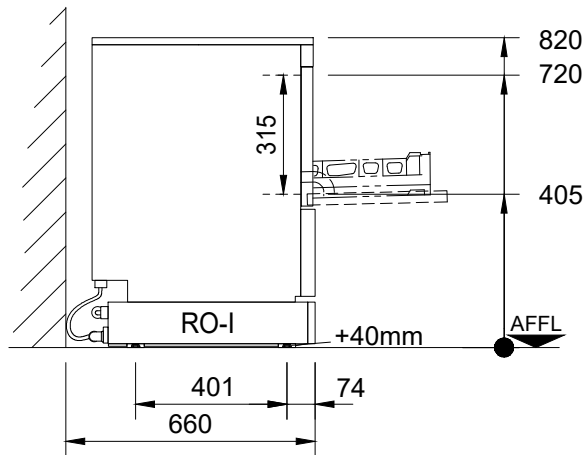
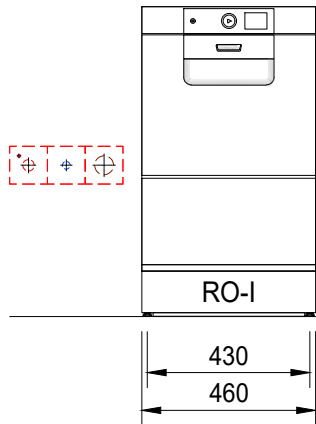

HOBART

!

GENERAL INFORMATION

!

Connections: The connection of the dishwasher to all services (e.g. electrical, water, drain, exhaust) must comply with all national and local codes of practice and must be carried out by qualified people.

Attention: If the dishwasher has a frequency inverter included and is connected after a RCD (FI PROTECTIVE SWITCH), this must be AC/DC sensitive type B.

Exhaust: A frost-protection flap is recommended if the exhaust air from the machine is ducted directly outside. If an exhaust hood is installed on top of the dishwasher, an airgap of min. 150mm needs to be maintained. Operational fluctuations can lead to a temporary higher exhaust temperature and humidity (VDI 2052).

Dimensions: Dimensions in the drawing are finished dimensions in Millimeters.

Transport: Minimum measurements of entry doors = outer largest dimension of machine height + 300mm; machine width + 400mm!

Shut-off valves: The isolating valves for rinse water, tank filling or demi-rinse are to be supplied by others.

Wash result: A streak free result is achievable with low mineral concentration of the rinse water only (see caption "water/conductivity). If necessary a de-mineralization system should be installed.

Floor drain: Splash floor drains should be installed for machine cleaning and for general cleaning purpose.

Ventilation: The ventilation and exhaust for the room must be according to VDI 2052. Radiated heat emissions must be considered.

Machine-Type: Compact Glasswasher with RO-I integrated				Heating: Electrical							
Model: PREMAX GCPROI-10C				Operation: front door							
Rack size: 400 x 400		Loading height: 315		Main-Switch: by others							
required supply (by others) (all installations according to local regulations) (technical feasibility must be checked on site)											
Electrical	Voltage	Frequency	Structure	Fuse	Total Load						
3.7	PA	Equipotential									
3.0	EZ	400 V	50 Hz	3-N-PE	3 x 16 A						
					4,7 kW						
Water	Consumption	Temp.	Hardness	Conductance	Dimension						
2.0	AW	Drain (Siphon provided by customer) / (max. drain height 800mm)			DN50						
1.0	KWw	1,7 l / Rack 8 l (Filling)	min. 10 °C max. 60°C	max. 12,5°e (0,5mmol/l) / 80µS/cm required water flow min. 5l/min	DN20						
					G ¾ male						
					400mm AFFL						
Water-Flow-Pressure provided by customer min. 1,5 bar / 14,5 psi - max. 6,0 bar / 85 psi											
The installation must be performed according to EN 61770. The corresponding back flow prevention type EA for the raw water supply is integrated in the RO. A back flow preve											
machine-side connentions and data											
AW Drain hose ID20 / OD25		2000 mm		AW Concentrate hose ID 21 / OD 28							
CH Supply hose for rinse aid		2500 mm		CH Supply hose for detergent, (blue marking)							
EZ Power cord		2000 mm		KWw Supply hose R¾							
				2000 mm							
Heat-Radiation of the machine (thermal output to the room)											
washware:		0,8 kW		latent:							
				0,4 kW							
				sensible:							
				0,3 kW							
Index	Änderungen / Changes				Datum / Date						
					Name						
Das Urheberrecht an dieser Zeichnung verbleibt bei der HOBART GmbH. Jede nicht von uns schriftlich genehmigte Benutzung, Vervielfältigung, Überlassung an Dritte ist strafbar und macht schadensersatzpflichtig.											
This document contains proprietary and confidential data of HOBART GmbH. No disclosure, reproduction or use of any part there of may be made without written permission of HOBART GmbH.											
Datum / Date:		Project:									
31.01.2024											
Gezeichnet / Drawn by:											
S.Doll											
Geprüft / Checked by:											
Projectmanager:		Maßstab / Scale:	Order-No.:	Zeichnungsnummer / Drawing-No.:							
		1:20 @ A3									

HOBART

HOBART GmbH

Robert-Bosch-Straße17

77656 Offenburg, Germany

Tel.: +49(0)781.600-0

Fax.: +49(0)781.600-2319

www.hobart.de

Datum / Date:

31.01.2024

Gezeichnet / Drawn by:

S.Doll

Geprüft / Checked by:

Projectmanager:

Maßstab / Scale:

1:20 @ A3

Order-No.:

Zeichnungsnummer / Drawing-No.:

release 02.2024

DIN A3 (420x297)

18-02